

DATASHEET

COMPARTMENT FLOOR WITH CEMENT SCREED

GD15.02

VISIBLE CEILING

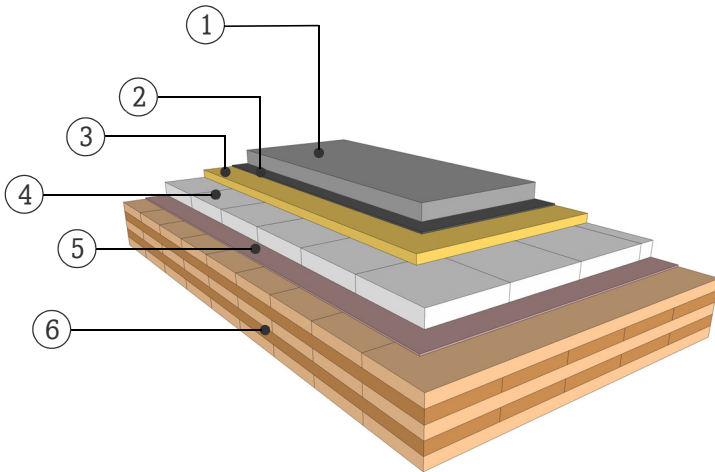

FIRE RESISTANCE

(R)EI 90 [min]

The fire resistance (R-criteria/structural resistance) up to 90 minutes applies for a maximum floor span of 4.2 m and given conditions with a fire exposure from one side. Should the planking material or the thickness deviate from stated information and a detailed examination of the actual load be required, please consult with a competent structural engineer of the KLH technical team.

SOUND INSULATION

R<sub>w</sub> (C;C<sub>tr</sub>) 60 (-1;-3) [dB]

L<sub>n,w</sub> (C<sub>i</sub>) 43 (1) [dB]

THERMAL CHARACTERISTICS

U 0,40 [W/m²K]

m<sub>w,B,A</sub> 36/106 [kg/m²]

MATERIAL

PROPERTIES

	[mm]		λ [W/mK]	μ min-max [-]	ρ [kg/m³]	c [kJ/kgK]	
①	60.0	Cement screed	1.4	50	2200	1.1	A1
②		Separating layer					
③	30.0	Impact sound insulation, s' ≤ 7 MN/m³	0.032	1	110	0.84	A1
④	50.0	Concrete elements	1.7	100	2400	1.08	A1
⑤	5.0	Acoustic sheet s' ≤ 115 MN/m³	0.045	20000	1400	1	E
⑥	145.0	5s TL, KLH solid timber slab	0.12	50 - 300	500	1.6	D

Thickness 290,0 [mm]

Mass per square meter ca. 325 [kg/m²]

Test report sound: HFA 169/2015-BB  
Calculation of the physical values by the  
KLH Massivholz GmbH, without warranty