

DATASHEET

COMPARTMENT FLOOR WITH CEMENT SCREED

GD18.02

VISIBLE CEILING

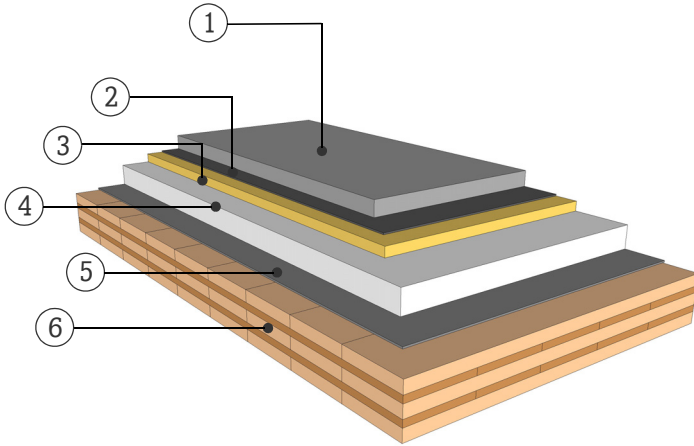

FIRE RESISTANCE

(R)EI 90 [min]

The fire resistance (R-criteria/structural resistance) up to 90 minutes applies for a maximum floor span of 4.2 m and given conditions with a fire exposure from one side. Should the planking material or the thickness deviate from stated information and a detailed examination of the actual load be required, please consult with a competent structural engineer of the KLH technical team.

SOUND INSULATION

R_w (C;C_{tr}) 58 (0;-3) [dB]

$L_{n,w}$ (C_i) 47 (0) [dB]

THERMAL CHARACTERISTICS

U 0,38 [W/m²K]

$m_{w,B,A}$ 35/106 [kg/m²]

MATERIAL

PROPERTIES

	[mm]		λ [W/mK]	μ min-max [-]	ρ [kg/m ³]	c [kJ/kgK]	
①	60.0	Cement screed	1.4	50	2200	1.1	A1
②		Separating layer					
③	30.0	Impact sound insulation $s' \leq 10 \text{ MN/m}^3$	0.032	1	110	0.84	A1
④	80.0	Gravel fill bonded	0.9	10	1450-1600	1	A1
⑤	5.0	Acoustic sheet $s' \leq 115 \text{ MN/m}^3$	0.045	20000	1400	1	E
⑥	160.0	5s TL, KLH solid timber slab	0.12	50 - 300	500	1.6	D

Thickness 335,0 [mm]

Mass per squaremeter ca. 335 [kg/m²]

Test report sound: HFA 2440/2017-BB
Calculation of the physical values by the
KLH Massivholz GmbH, without warranty